

LAYOUT NOTES

1. DIMENSIONS SHOWN ARE FOR REVIEW ONLY. REFER TO CIVIL SHEET C&I ON LIFTING LAYOUT FORMAT AND CRITICAL DIMENSIONS.
2. REFER TO CIVIL SHEET C&I FOR TRAIL ENCLOSURE DIMENSIONS AND LOCATION.
3. RETRACK OFF OF BRIDGES LANE IS TO BE 10'
4. ALL BUILDINGS ARE TO BE A MINIMUM OF 10' APART.
5. RETRACKS OFF OF PRIVATE DRIVE ARE TO BE 10'

NOTE:
ROCK WALL SHALL CONFORM TO STANDARDS AND GUIDELINES PER AMERICAN ROCKERY CONTRACTORS' ROCK WALL CONSTRUCTION GUIDELINES

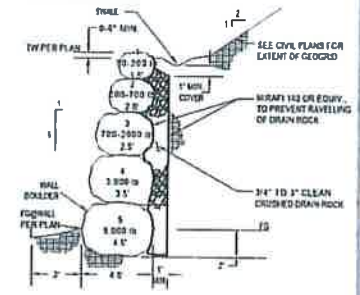

1. SLOPES ABOVE ROCK WALL SHALL NOT EXCEED 2:1.
2. ROCK WALL SHALL HAVE A 1:8 BATTER.
3. LOWEST ROCK SHALL BE KEYS A MINIMUM OF 2' DEEP OR 5' TO DAYLIGHT, WHICHEVER IS GREATER.

1 Typical Wall Detail
SCALE: 1/4" = 1'

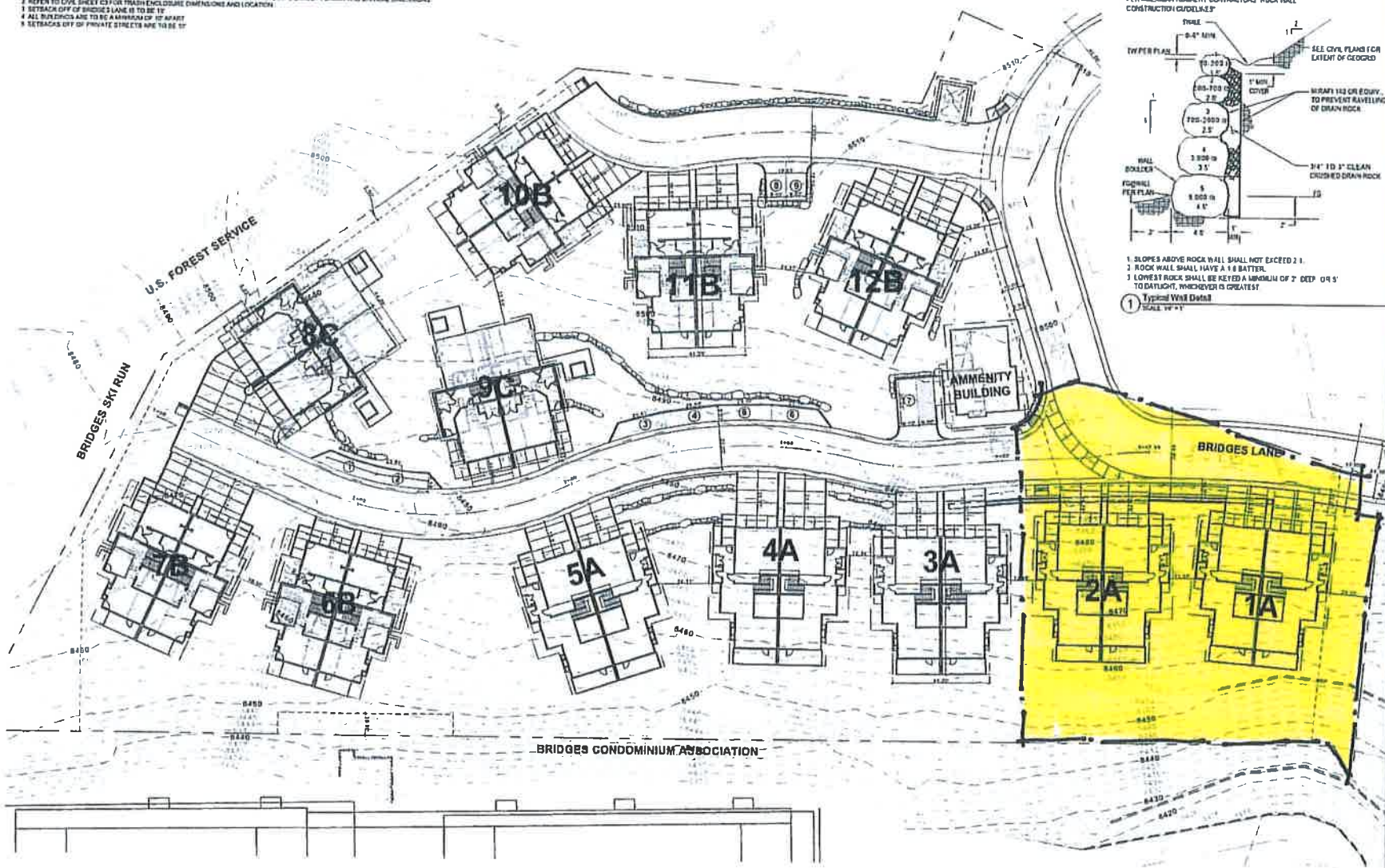

Altis at Mammoth Lakes

INTRASTAR
8900 South McCarran Blvd
Ste. 3000
Reno, NV 89509

DATE	NOTES

TTM-UPA SUBMITTAL



LAYOUT PLAN
L1.0

DRAFT



